

-----

THIS DOCUMENT COULD CONTAIN TECHNICAL DATA, THE EXPORT OF WHICH IS RESTRICTED BY THE U.S. ARMS EXPORT CONTROL ACT (AECA) (TITLE 22, U.S.C. SEC 2751, ET SEQ.) OR THE EXPORT ADMINISTRATION ACT OF 1979, AS AMENDED (TITLE 50, U.S.C., APP. 2401, ET SEQ.). TECHNICAL DATA AUTHORIZED FOR EXPORT MAY NOT BE REEXPORTED, TRANSFERRED, OR DIVERTED FROM THE COUNTRY OF ULTIMATE END-USE OR FROM THE AUTHORIZED FOREIGN END-USER OR DISCLOSED TO A NATIONAL OF ANOTHER COUNTRY WITHOUT THE PRIOR WRITTEN APPROVAL OF THE OFFICE OF DEFENSE TRADE CONTROLS. TECHNICAL DATA CONTAINED IN THIS DOCUMENT HAS BEEN AUTHORIZED FOR EXPORT FROM THE UNITED STATES TO FOUR-EYES ALLIED PARTNERS, NATIONALS OF AUSTRALIA, CANADA, AND THE UNITED KINGDOM BY THE OFFICE OF DEFENSE TRADE CONTROLS, IN SO FAR AS INDIVIDUAL NATIONALITY IS NOT DIVERSE FROM HIS OR HER EMPLOYING AGENCY.

-----



---

# Empire Challenge 2008

## JSBA 2008

China Lake, CA  
1/29/2008

Louis C Miller (471600D)  
760.939.0018  
louis.miller@navy.mil



# China Lake Security

---

## 1. SECRET (GENSER) visit requests

Mailing Address: Commanding Officer  
NAVAIRWPNSTA  
Attn: Security (Lee McDowell)  
1 Administration Circle  
China Lake, CA 93555-6100

FAX: (760) 939-3996

JPAS SMO 476096

Voice (verification): (760) 939-3005

## 2. SCI Access & SI/TK Clearances

Send Official Message to:

//SSO CHINA LK// Fax: (760) 939-1746

SSO: Catherine Mattox, Voice: (760) 939-1567

Asst SSO: Jerry Broaker, Voice: (760) 939-1504

EC08 POC: Louis C Miller, Voice: (760) 939-0018

## 3. US Citizens - We need your SSN to get badge letters (MNFS)

FAX a copy of your visit request to: (760) 939-1840

Voice (verification): (760) 939-8746

## 4. POCs for Assistance:

FN: Theresa Goldstrand (760) 939-3842

US: Sandra Gamble (760) 939-8746

# Security – Visitor Do's and Don'ts

---

- **DO**

- Obey base speed limits
- Carry vehicle documents
- Respect local PD
- Carry ID & PSP docs
- Pay attention to rules
- Be aware of your location
- Follow OPSEC procedures
- Drink lots of water

- **DON'T**

- Use cameras
- Use transmitters
- Leave your Cell phone in the Car
- Use listening devices
- Wander about
- Travel off-road
- Molest the wildlife
- Molest the Historical sites
- Bring Camera Phones on base
- Carry a Cell phone of any kind to ECHO

***Failure to follow procedures will result in excuse from EC08!***

# Additional Information from FN Visitors

---

- **Please submit Visit requests as soon as possible**
  - The more time we have to work the Cases the better
  - Make the cases accurate for who is coming and when
- **So we only need to do the PSP once:**
  - If you are bringing a Laptop or Portable Printer we need the:
    - Make
    - Model
    - Serial Number
  - Please include a list of people from your country that will have EC cell phones
- **Fax a copy of your visit request to: (760) 939-6856**

Voice (verification): (760) 939-3842

# Driving into the Valley...

## THE INDIAN WELLS VALLEY

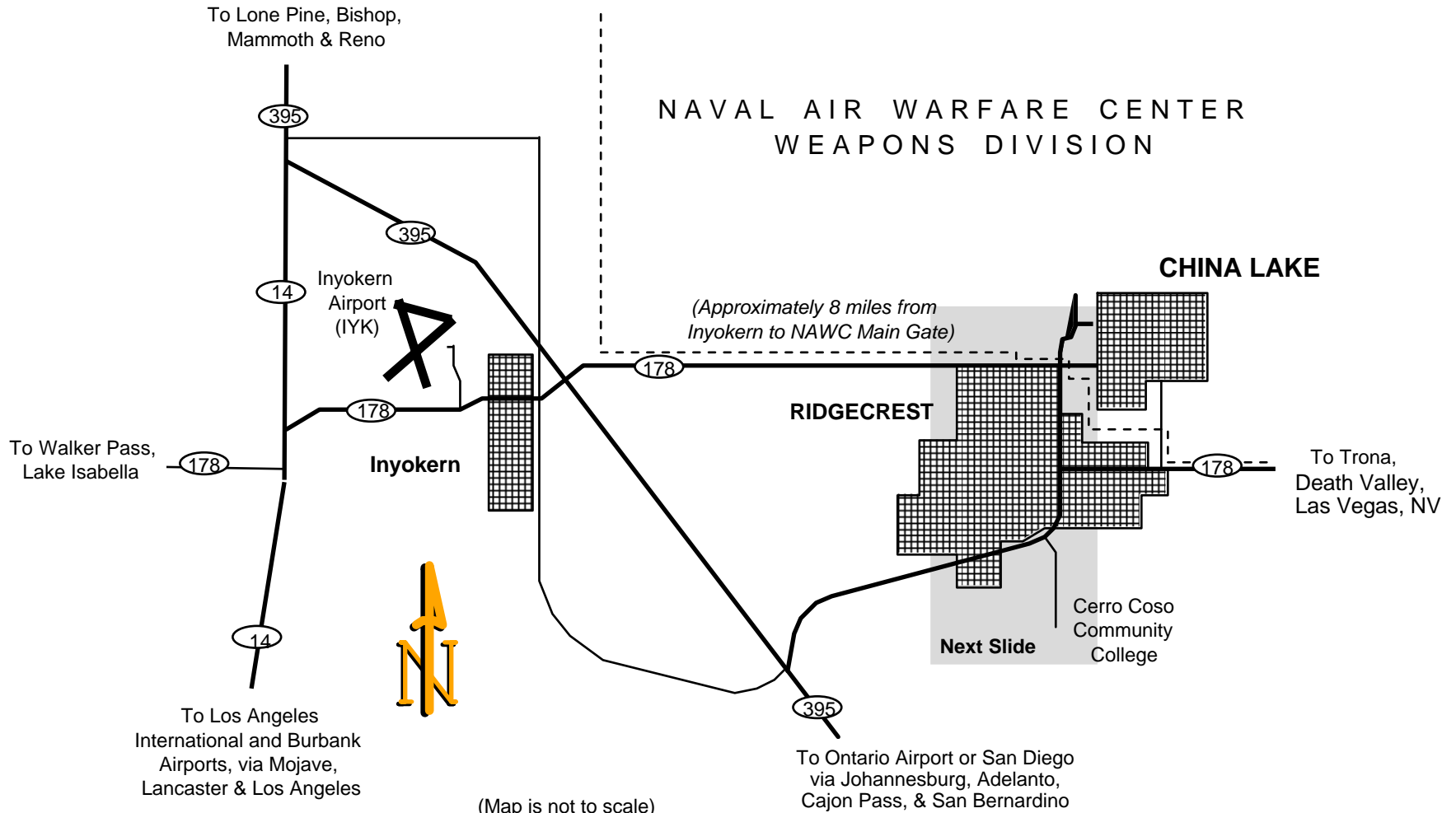

(Map is not to scale)

# Finding your Hotel...

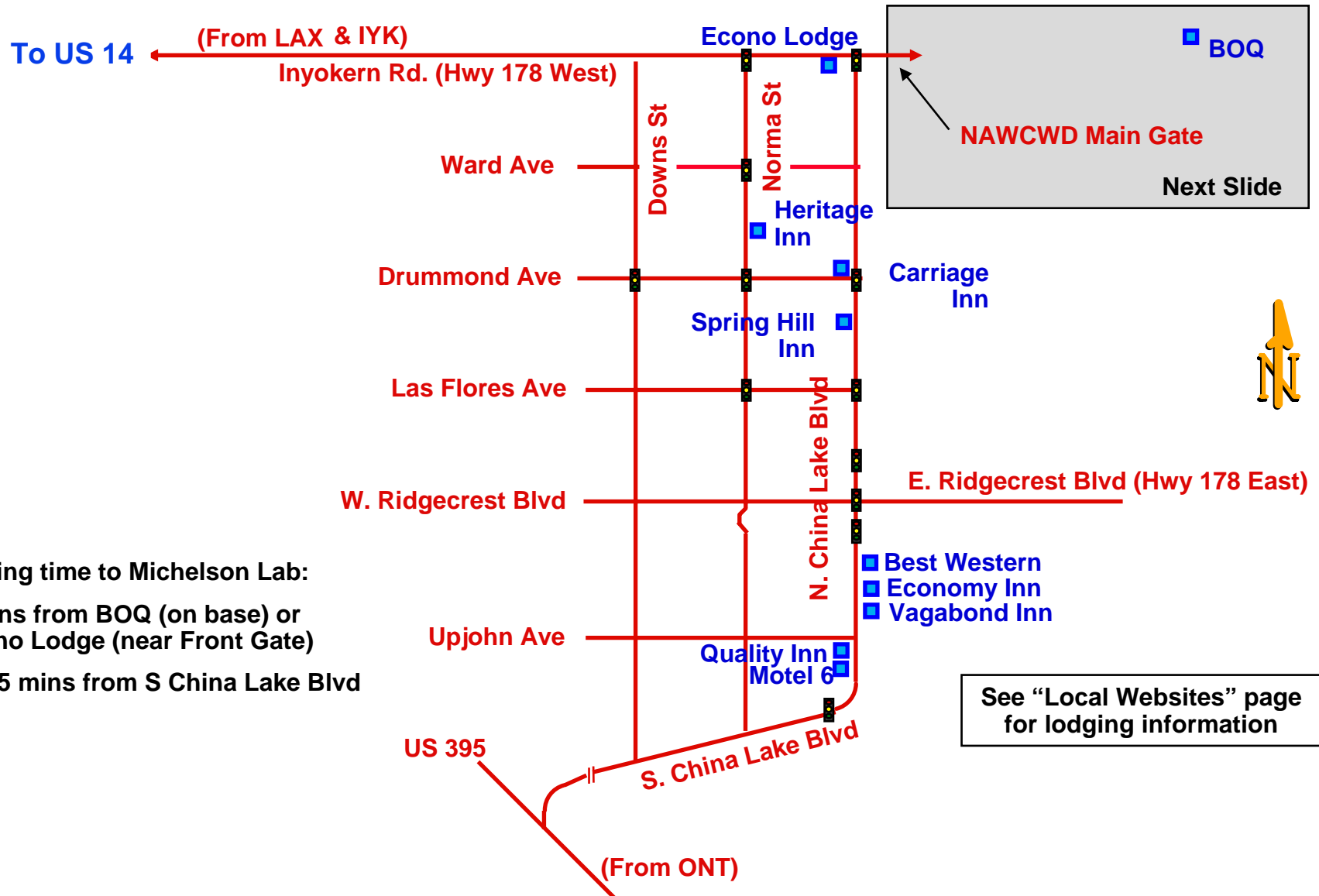

Driving time to Michelson Lab:

5 mins from BOQ (on base) or Econo Lodge (near Front Gate)

10-15 mins from S China Lake Blvd

See "Local Websites" page for lodging information

# Arriving on Base...

Stop outside the Main Gate and go into the Pass Desk (on right) to pick up your badge. Show it to the guard at the Main Gate as you enter.

Proceed East on Inyokern Rd. and go 3/4 of the way around traffic circle to North Knox Rd. Continue on Knox past the stop sign at Blandy Ave. and take the first left into Michelson Lab parking lot. You will be facing the Main Entrance as you enter the parking lot. Call 939-8274 or -0044, -8746, -3045, -8119 from inside first set of doors and someone will escort you.

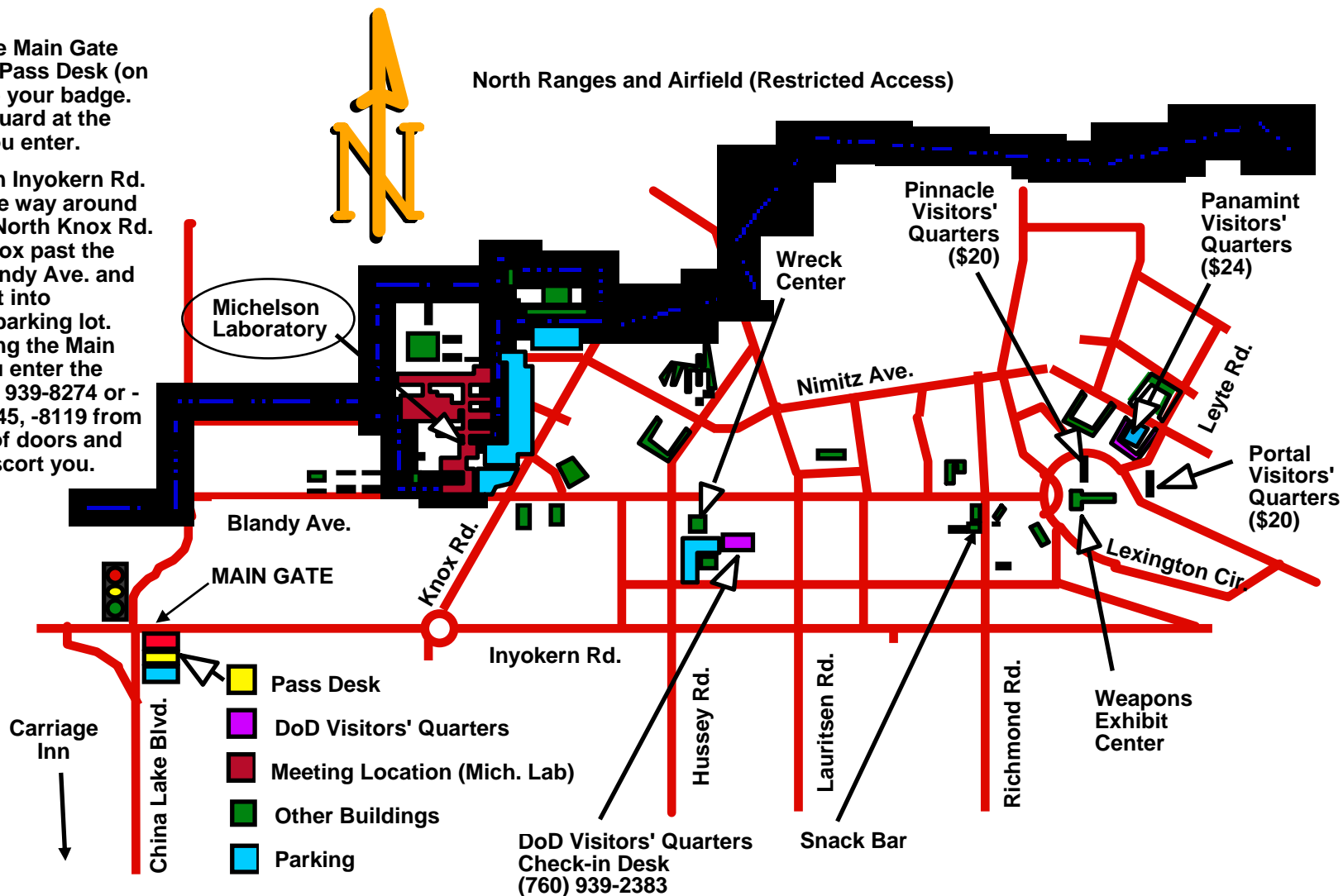



# MICHELSON LABORATORY

## EEC Visitor Workspace Areas

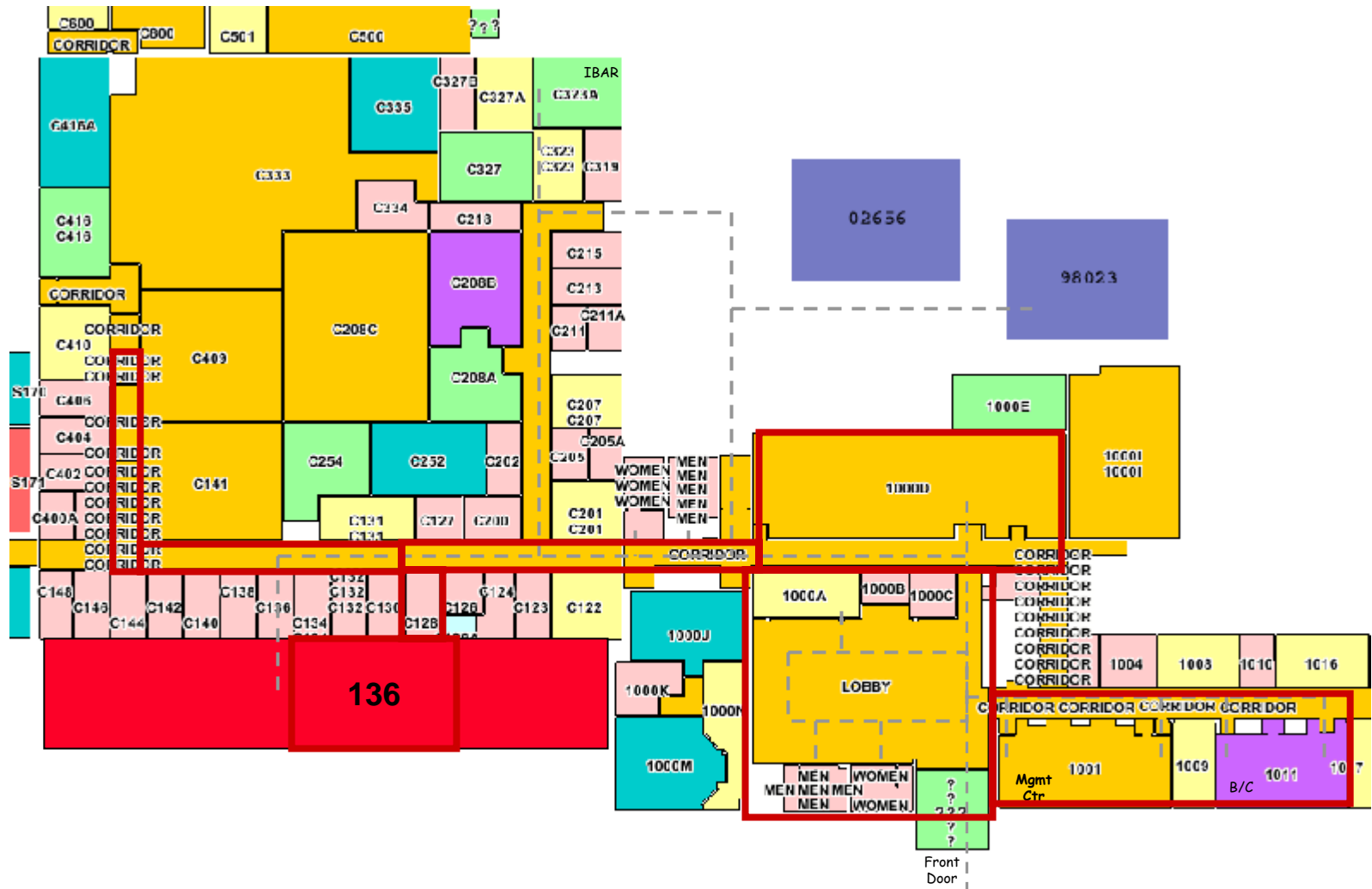

# Driving to the ECR...

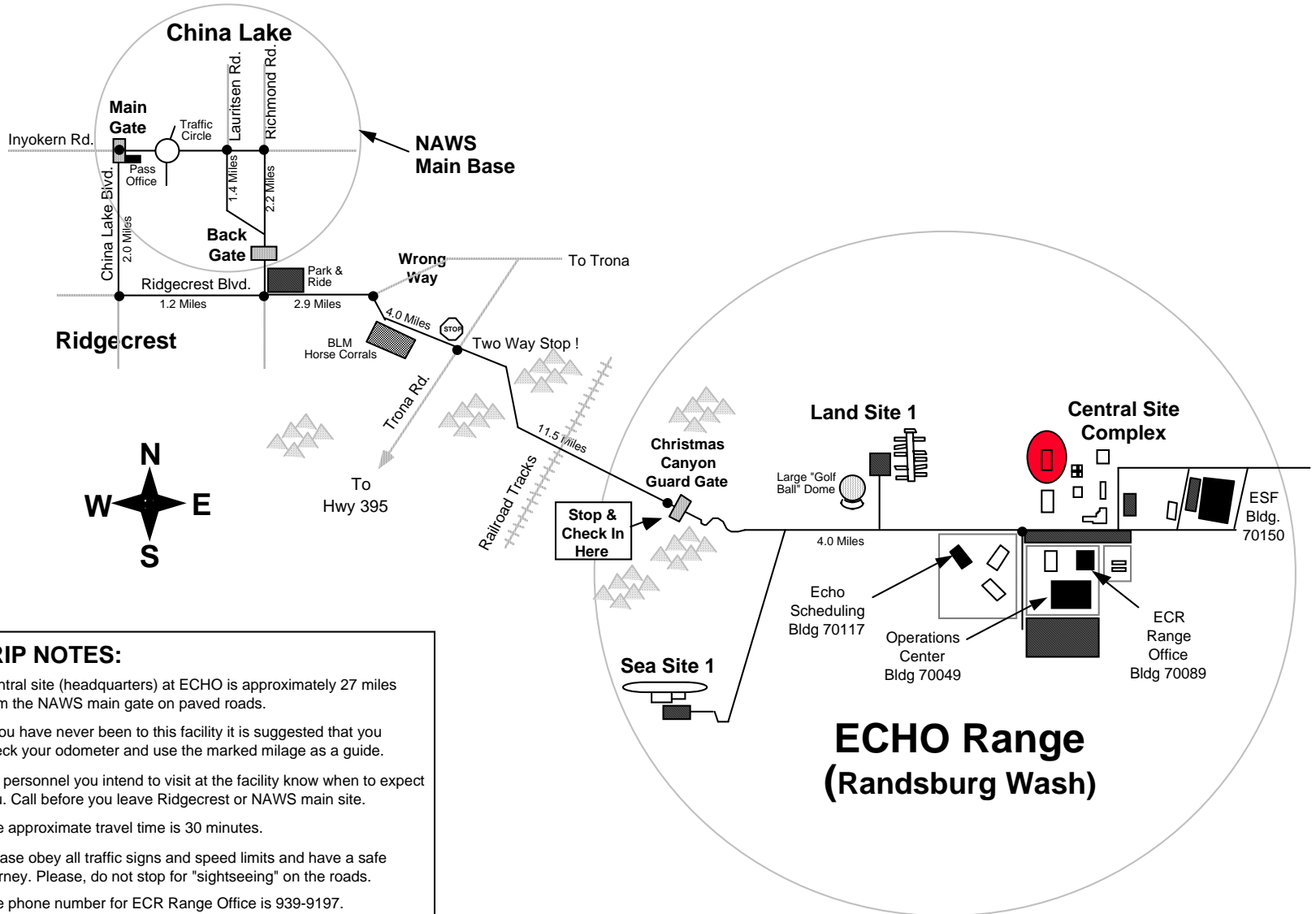

## TRIP NOTES:

Central site (headquarters) at ECHO is approximately 27 miles from the NAWS main gate on paved roads.

If you have never been to this facility it is suggested that you check your odometer and use the marked mileage as a guide.

Let personnel you intend to visit at the facility know when to expect you. Call before you leave Ridgecrest or NAWS main site.

The approximate travel time is 30 minutes.

Please obey all traffic signs and speed limits and have a safe journey. Please, do not stop for "sightseeing" on the roads.

The phone number for ECR Range Office is 939-9197.

● = Mileage Markers

■ = Parking Area